

▶▶ S422系列脉冲群抑制器



特征

- ◆ 依据IEC61000-4-4, GB/T17626.4标准设计
- ◆ 能有效抑制5/50ns的4KV尖峰脉冲

典型应用

- ◆ 铁路自动化控制器
- ◆ 通讯基站产品
- ◆ 实验仪器仪表
- ◆ 计算机及其周边

技术参数

额定电压	250VAC
工作频率	50/60Hz
线-线耐压	1500VDC
线-地耐压	2000VAC
绝缘电阻	>100MΩ @500VDC
工作温升	<30°C@40°C
气候类别 (IEC 60068-1)	25/085/21

选型列表

产品型号	额定电流(A)	泄漏电流 (mA) @250VAC	外壳	连接端子	
				通用	可选
DTS422-1-W20-B15	1	<0.5	B15		
DTS422-3-F8-D15	3	<0.5	D15		
DTS422-6-F8-D15	6	<0.5	D15		
DTS422-10-M6-D35	10	<0.5	D35		
DTS422-20-M6-D45	20	<0.5	D45		

S422系列脉冲群抑制器

插入损耗

—— 共模 - - - - - 差模 (50 Ω / 50 Ω 测量系统 符合IEC/CISPR NO. 17)

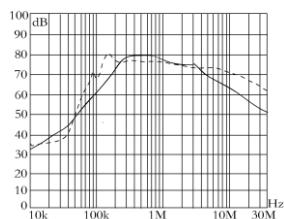

DTS422-1-F8-D15

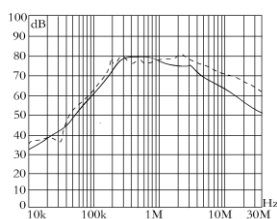

DTS422-3-F8-D15

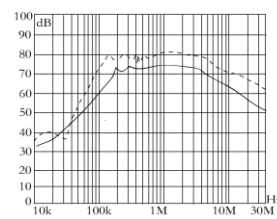

DTS422-6-F8-D15

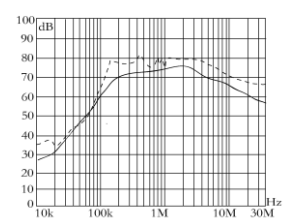

DTS422-10-M6-D35

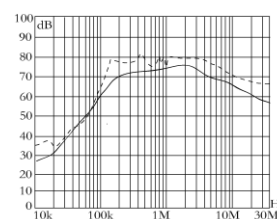

DTS422-20-M6-D45

外形尺寸(mm)

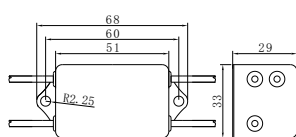

B15(W20)

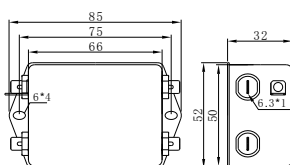

D15(F8)

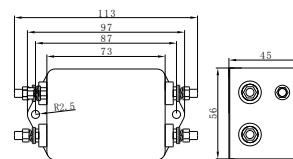

D35(M6)

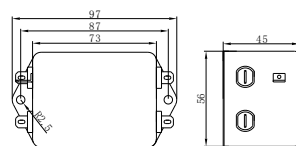

D35(F8)

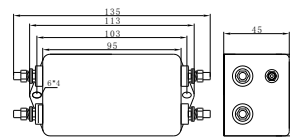

D45(M6)

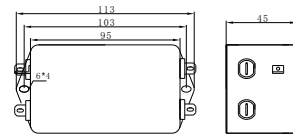

D45(F8)